



## Weaver Lake Office Park

11322 86th Ave. N.

Maple Grove, MN 55369

**FOR SALE**  
**3,584 SF Office Condo**



### FEATURES:

- 3,584 SF Office Condo includes two levels.
- 1,792 SF Main Level includes 5 Offices, Conf. Room, Work Room & Reception Area.
- 1,792 SF Lower Level includes 5 Offices, Conf. Room, 2 Bathrooms & Storage Room.
- Walkout area to quiet & scenic pond / nature area
- Perfect for any small company looking to own!

**Sale Price:**  
**\$475,000**



### FACTS:

- ▲ Many high end finishes throughout!
- ▲ Convenient Location off Zachery Lane & Weaver Lake Rd minutes away from 694
- ▲ Many restaurants & retail in close proximity
- ▲ Association Dues: \$638 per month.

Overview .....	1
Aerial Maps .....	2
Property Info .....	3
Floor Plan .....	4
Photo Gallery .....	5-6



**Chad Weeks**  
612.619.9911  
cweeks@arrowcos.com



**Jeff Penfield**  
612.325.2067  
jpenfield@arrowcos.com

### Contact

Phone: 763.424.6355  
Fax: 763.424.7980

Arrow Companies  
7365 Kirkwood Court N. Suite 335  
Maple Grove, MN 55369

[www.arrowcos.com](http://www.arrowcos.com)

AERIAL & MAP

FOR SALE  
3,584 SF Office Condo

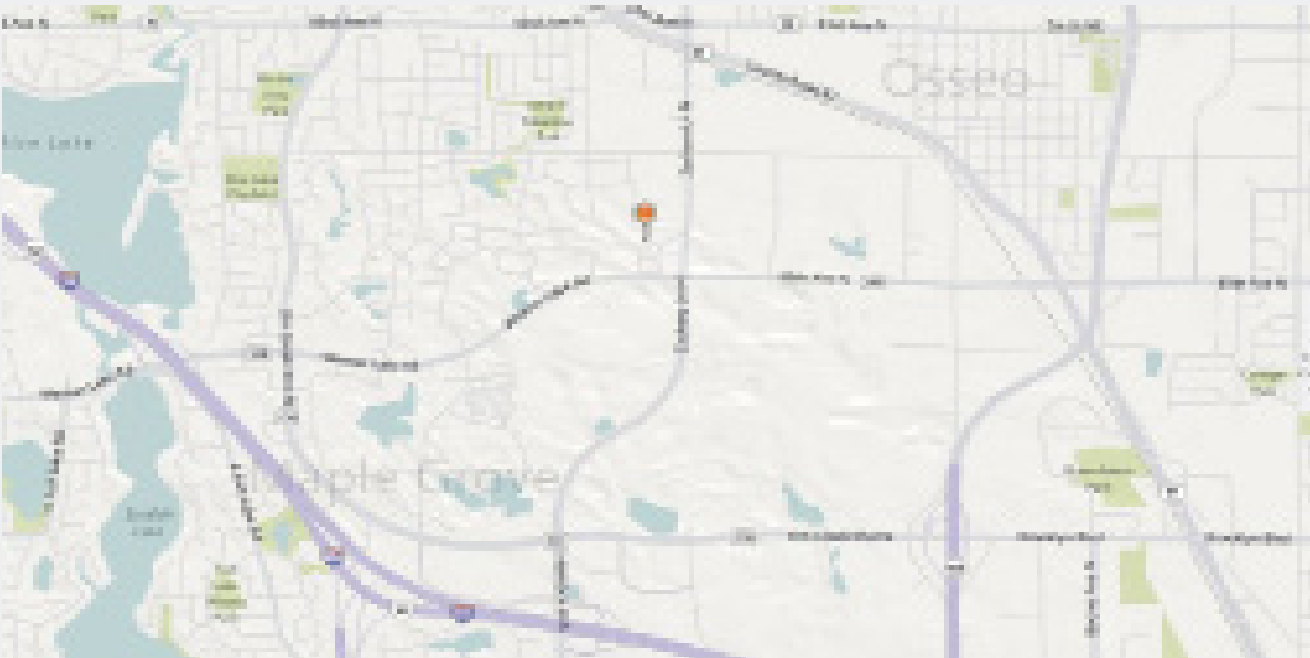
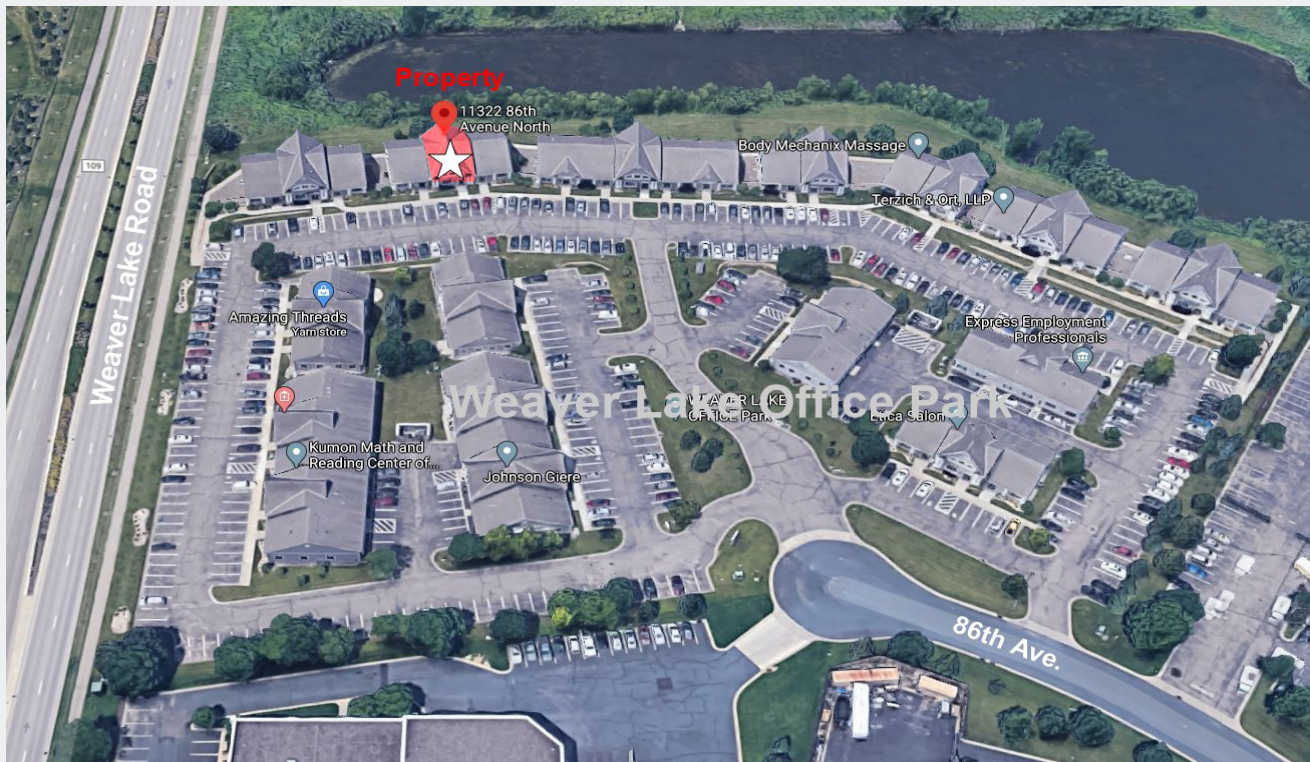

Contact

Phone: 763.424.6355

Fax: 763.424.7980

Arrow Companies

7365 Kirkwood Court N. Suite 335

Maple Grove, MN 55369

[www.arrowcos.com](http://www.arrowcos.com)



## Weaver Lake Office Park

11322 86th Ave. N.

Maple Grove, MN 55369

### PROPERTY FACTS

**FOR SALE**  
**3,584 SF Office Condo**

BUILDING SIZE	1,792 SF - Main Level <u>1,792 SF - Lower Level</u> 3,584 Total SF
YEAR BUILT	2003
ASSOCIATION	Weaver Lake Office Park
PID #	14-119-22-44-0081
ZONING	Commercial Preferred
CONSTRUCTION	Wood Framed with Brick
ASSOCIATION DUES	\$638 per month
2020 REAL ESTATE TAXES	\$12,579.96

#### Contact

Phone: 763.424.6355

Fax: 763.424.7980

Arrow Companies

7365 Kirkwood Court N. Suite 335

Maple Grove, MN 55369

[www.arrowcos.com](http://www.arrowcos.com)



PHOTO GALLERY

**FOR SALE**  
**3,584 SF Office Condo**



**11322 86th Ave.**  
**(3,584 SF)**

**FLOOR PLAN**

**Contact**

Phone: 763.424.6355

Fax: 763.424.7980

Arrow Companies

7365 Kirkwood Court N. Suite 335

Maple Grove, MN 55369

[www.arrowcos.com](http://www.arrowcos.com)

PHOTO GALLERY

FOR SALE  
3,584 SF Office Condo



Reception Area



Conference Room



Office

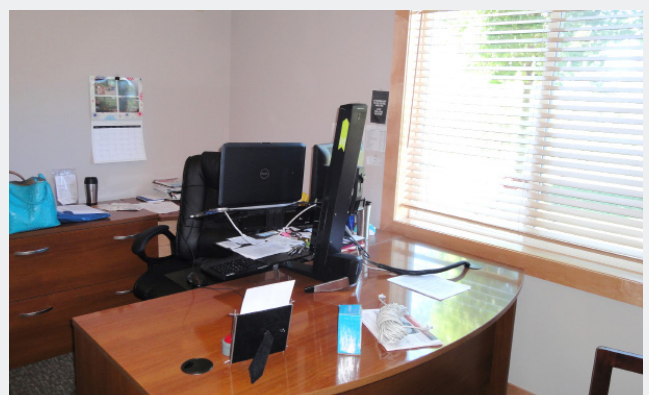

Office



Office



Office

Contact

Phone: 763.424.6355

Fax: 763.424.7980

Arrow Companies

7365 Kirkwood Court N. Suite 335

Maple Grove, MN 55369

[www.arrowcos.com](http://www.arrowcos.com)

OUTSIDE GALLERY

FOR SALE  
3,584 SF Office Condo



Contact

Phone: 763.424.6355

Fax: 763.424.7980

Arrow Companies

7365 Kirkwood Court N. Suite 335

Maple Grove, MN 55369

[www.arrowcos.com](http://www.arrowcos.com)